



QUEEN OF PEACE CATHOLIC CHURCH

OLIVE BRANCH, MISSISSIPPI



Master Plan
May 20, 2013

Process

- Research and Programming
 - Programming
 - Questionnaire
 - Meetings
 - Square Footage Analysis
 - Goals & Objectives
 - Zoning Code Review
 - Building Code Review
- Feasibility and Conceptual Design
 - Site Analysis Drawings
 - Site Design Studies
 - 3-Dimensional Drawing Studies
 - Presentation of drawings to Committee

LEGEND

- WORSHIP
- CHURCH LIFE & EDUCATION
- ADMINISTRATION
- CIRCULATION
- MISCELLANEOUS



Existing Plan

Existing Area: 18,206 SF

Program:

- Worship: 30,866 SF
- Christian Education: 6,688 SF
- Administration: 600 SF
- TOTAL: 38,154 SF

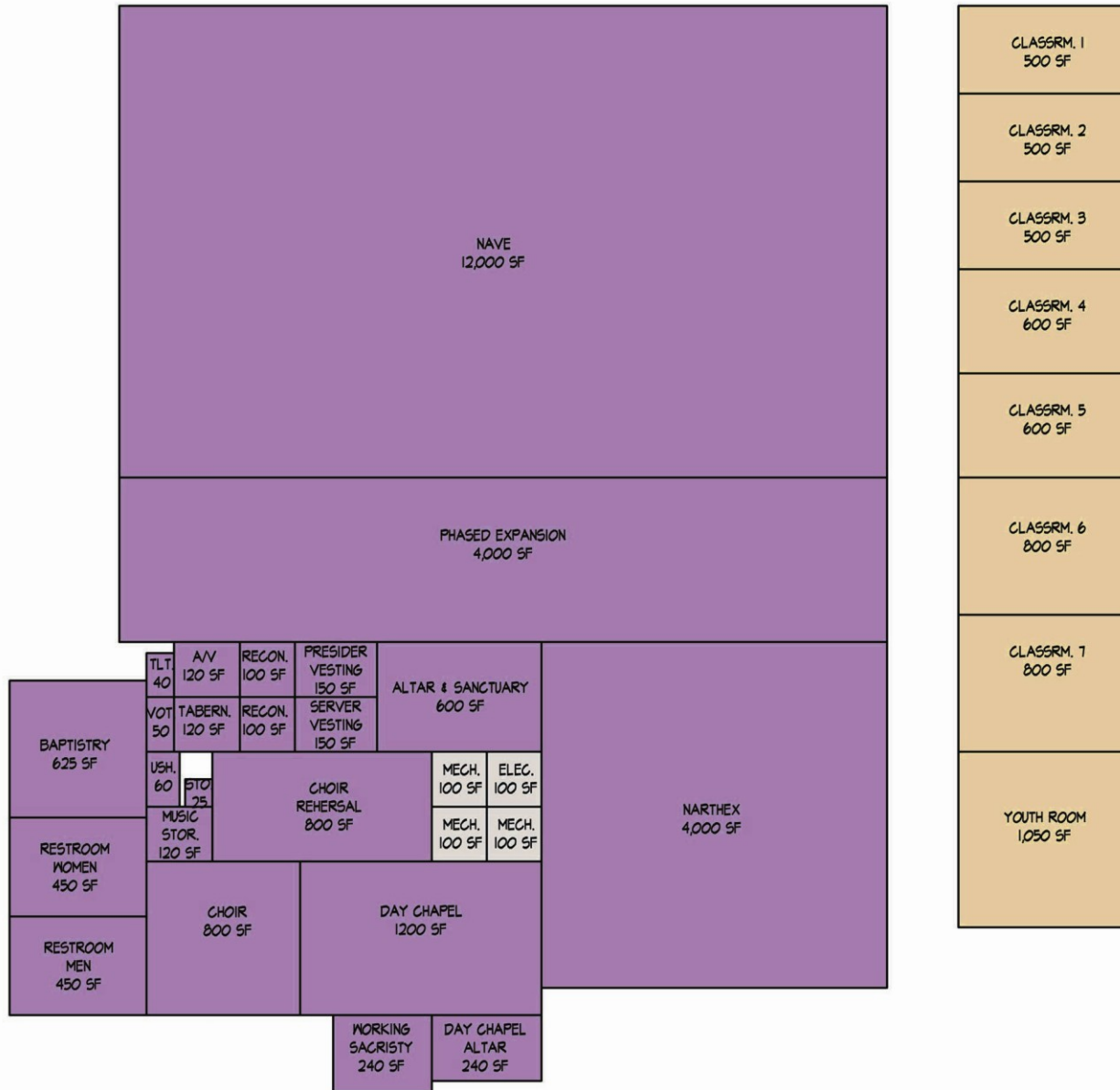

LIT. MIN. 120 SF	SCH. OFF. 120 SF
DRE OFF. 120 SF	ADD OFF. 120 SF

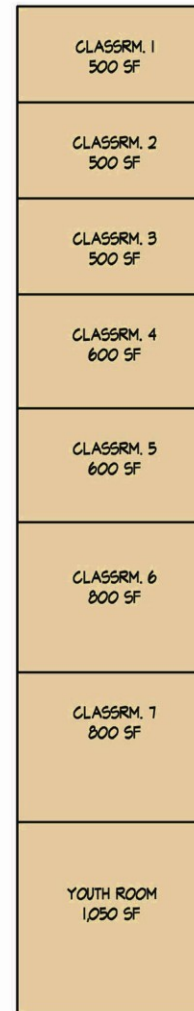

Program Blocks



Site Analysis

197 Existing Parking Spaces

9.1 Acres



Scheme A



Site Plan

524 Total Parking Spaces

9.1 Acres



Scheme A

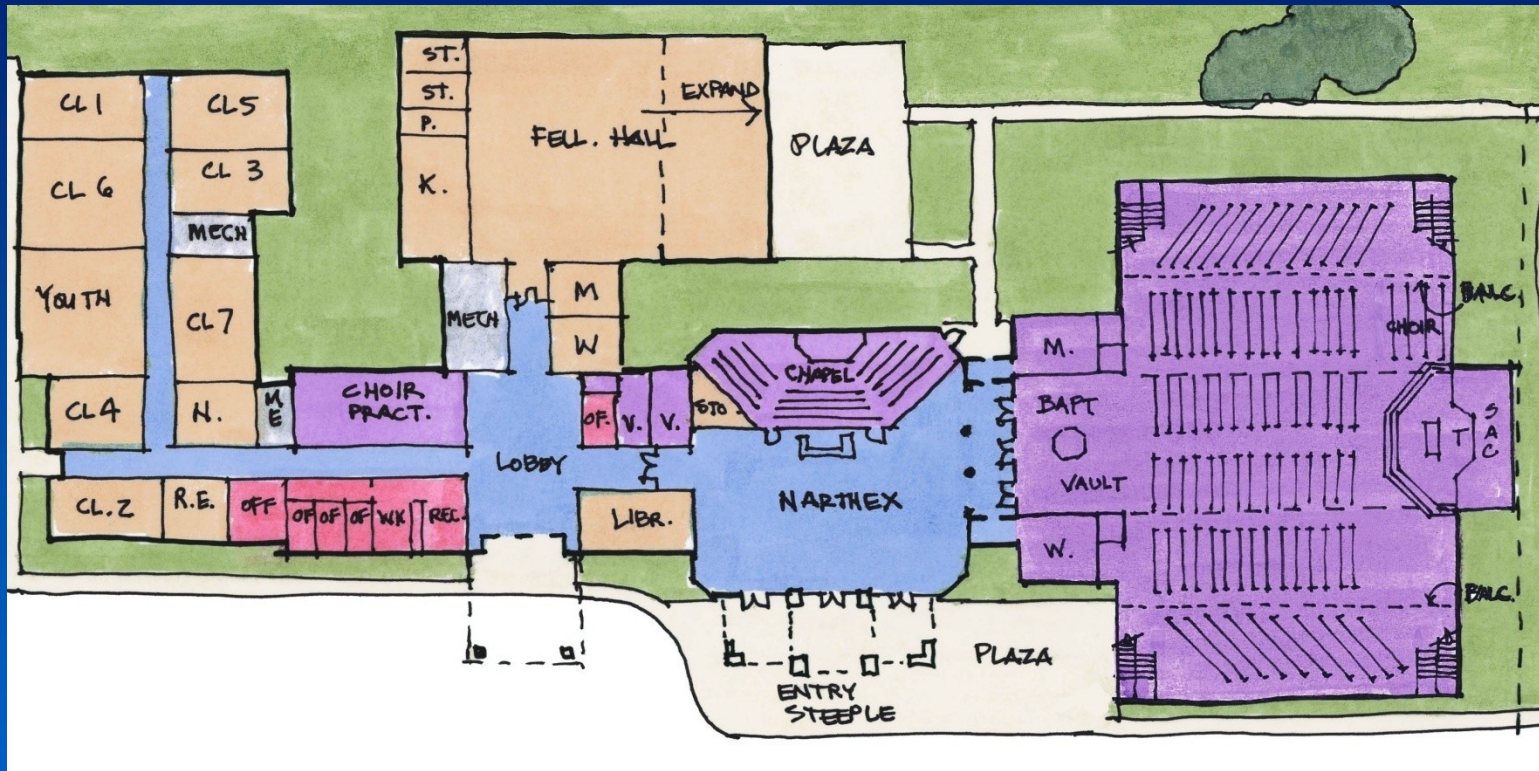

Floor Plan

Scheme A



Exterior Perspective

Scheme A



Interior Perspective

Scheme A:

- Existing Area: 18,205 SF
- Proposed Area: 20,150 SF
- TOTAL: 38,355 SF
- Renovated Area: 14,879 SF

Scheme B



Site Plan

443 Total Parking Spaces
11.8 Acres



Scheme B

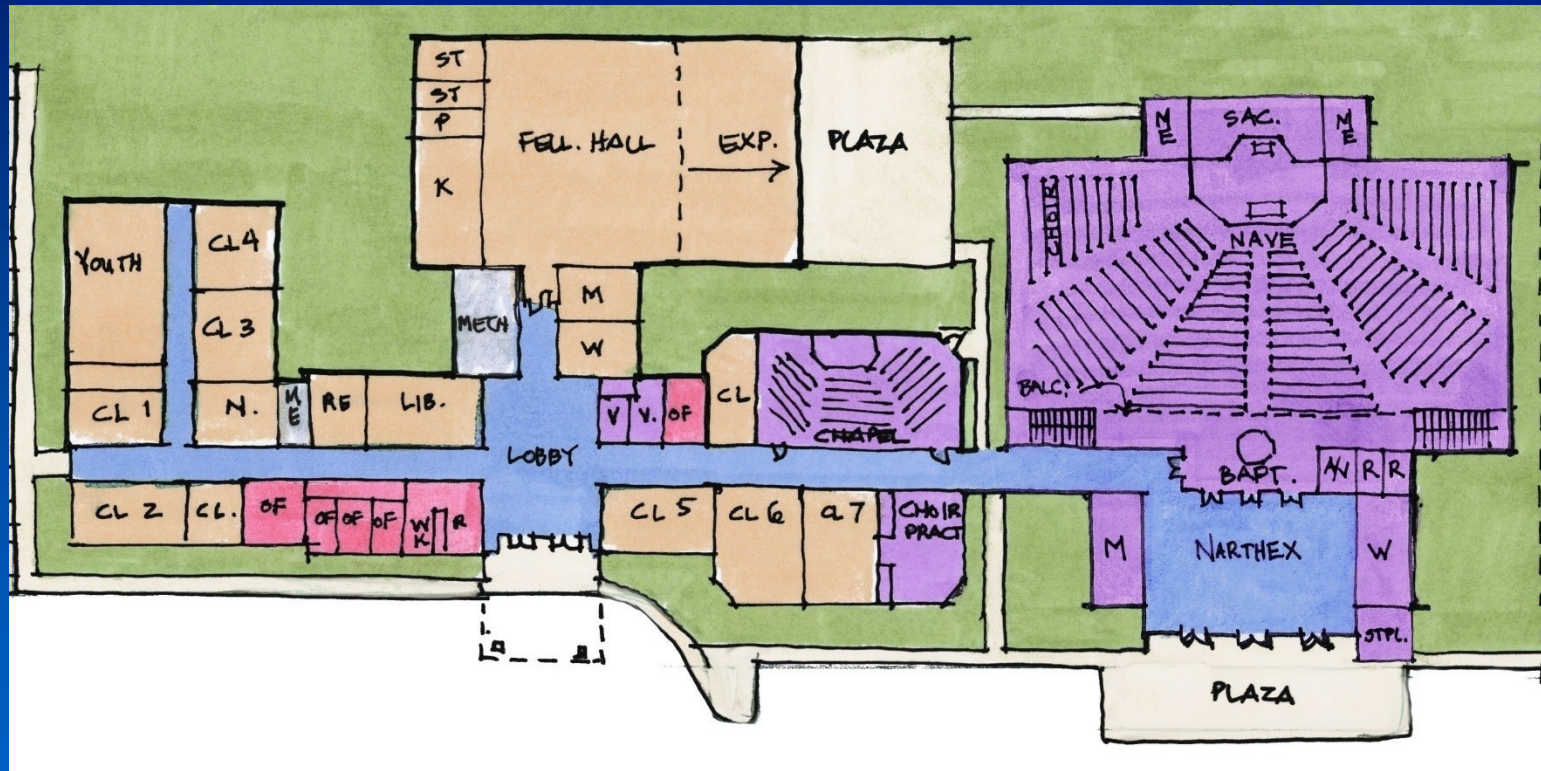

Floor Plan

Scheme B

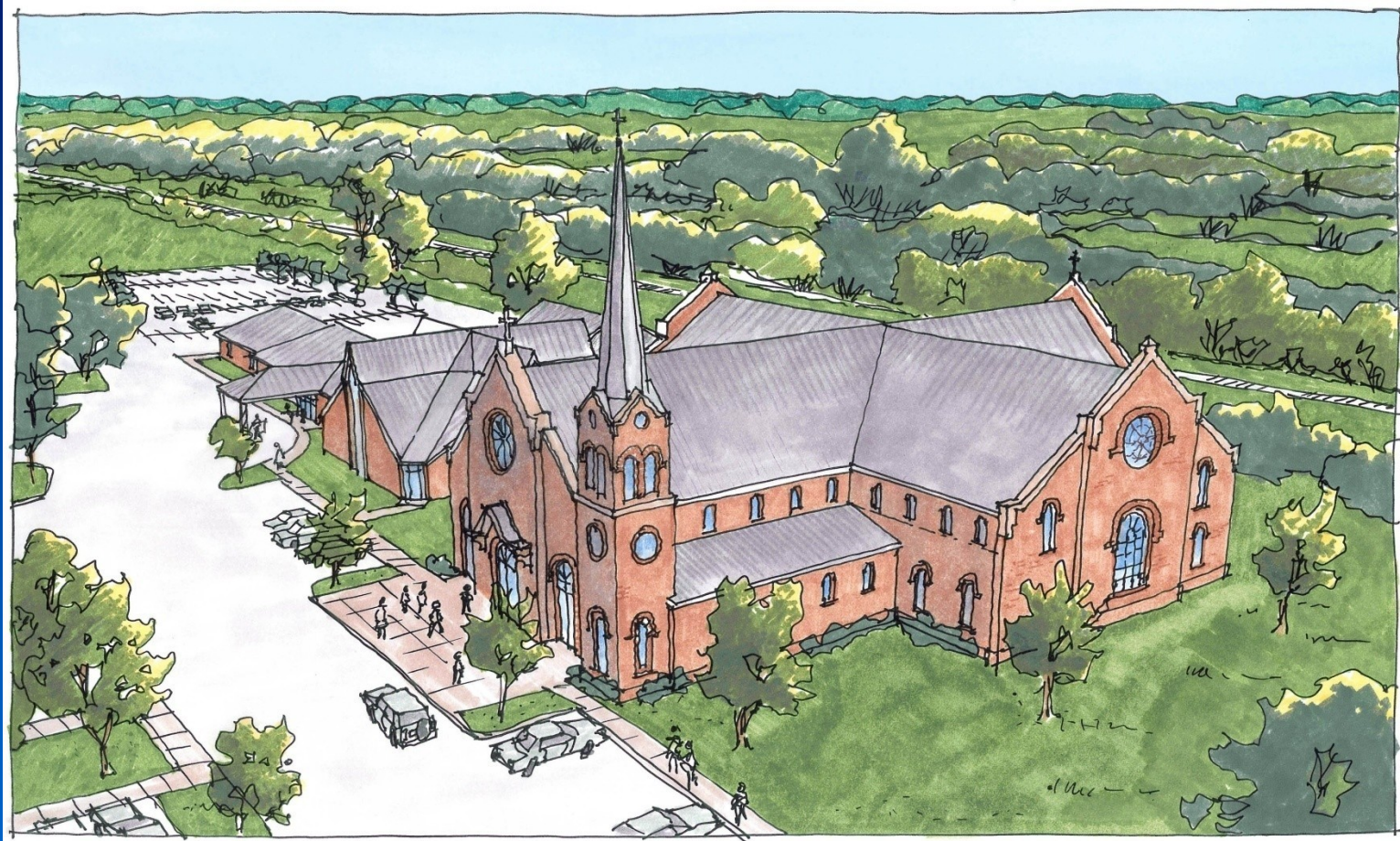

Exterior Perspective

Scheme B

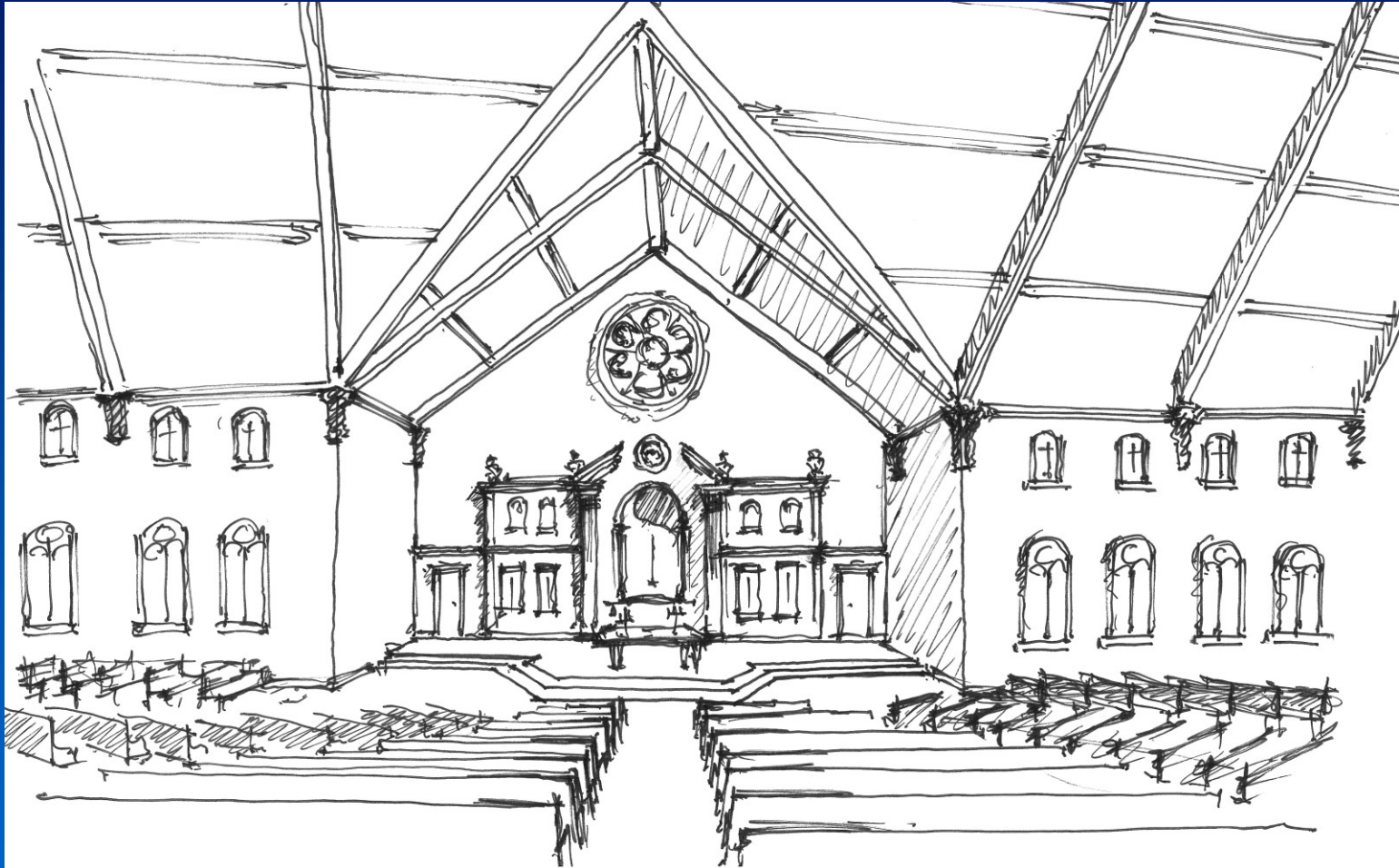

Interior Perspective

Scheme B:

- Existing Area: 18,205 SF
- Proposed Area: 19,134 SF
- TOTAL: 37,339 SF
- Renovated Area: 14,879 SF



QUEEN OF PEACE CATHOLIC CHURCH

OLIVE BRANCH, MISSISSIPPI



Master Plan
May 20, 2013

Phasing: Scheme A

- Phase I:
 - New Worship Building: 14,600 SF
 - Renovation Existing Worship: 4,900 SF
- Phase II:
 - Education Wing Addition: 4,475 SF
 - Renovate Existing Education Wing: 4,920 SF
- Phase III:
 - Fellowship Hall Addition: 1,600 SF
- Phase IV:
 - Worship Balcony Expansion: 4,300 SF